

**Anchor shackles.**

**Technical instruction :**

U.S. Federal Specification (RR - C.271b type IV classe1)

Safety factor : 6 up to 55 t

Testing load : 2 x s.w.l. and according to I.L.O.  
Safe working load permanently shown on every shackle

Finish : painted or galvanised

Pins : alloys steel

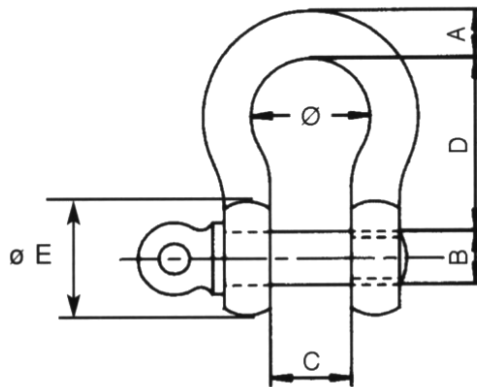

Dynafor Models	Code	S.W.L Tons	A mm	B mm	C mm	D mm	Ø mm	ØE mm	Weight mm
LLX-0.25 to 1.25	47906	1.5	11	13	18	43	29	26	0.2
LLX-2.5	47916	3.25	16	20	27	60	42	40	0.6
LLX-5	47926	6.5	22	25	37	84	58	50	1.4
LLX-12.5	47936	13.5	35	38	57	132	89	86	4.4
LLX-25	47946	25	44	50	73	178	110	104	14
LLX-50	47956	50	64	70	105	267	150	146	39.7
LLX-100	38166	100	89	95	146	381	241	195	97
LLX-250	93106	250	125	140	200	540	320	290	340